

グロメット KG-B



仕様・用途

仕様 材質 EPDM=黒

硬度 50° ±5

用途 配電盤・制御盤・計測機器等

◎受注ロットは100ヶ単位になります。

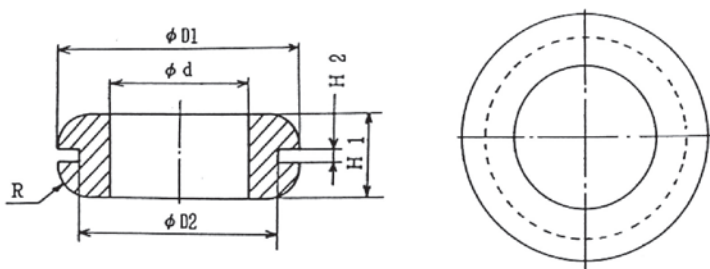

5825番号	旧 番号	H1	H2	φD1	φD2	φd	R	重量(g)	F 番号	備考
KG-B061B	B6-1	7.0	1.0	18.0	12.0	6.0	3.0	1.5	B6-1F	
KG-B062B	B6-2	8.0	2.0	18.0	12.0	6.0	3.0	1.7	B6-2F	
KG-B081B	B8-1	7.0	1.0	20.0	14.0	8.0	3.0	2.0	B8-1F	
KG-B082B	B8-2	8.0	2.0	20.0	14.0	8.0	3.0	2.2	B8-2F	
KG-B101B	B10-1	8.0	1.0	22.0	16.0	10.0	3.0	3.1	B10-1F	
KG-B102B	B10-2	9.0	2.0	22.0	16.0	10.0	3.0	3.5	B10-2F	
KG-B121B	B12-1	10.0	1.0	26.0	19.0	12.0	4.0	5.0	B12-1F	
KG-B122B	B12-2	11.0	2.0	26.0	19.0	12.0	4.0	5.3	B12-2F	
KG-B141B	B14-1	10.0	1.0	29.0	22.0	14.0	4.0	6.3	B14-1F	
KG-B142B	B14-2	11.0	2.0	29.0	22.0	14.0	4.0	6.8	B14-2F	
KG-B161B	B16-1	10.0	1.0	32.0	25.0	16.0	4.0	8.0	B16-1F	
KG-B162B	B16-2	11.0	2.0	32.0	25.0	16.0	4.0	8.8	B16-2F	
KG-B191B	B19-1	12.0	1.0	35.0	28.0	19.0	5.0	10.0	B19-1F	
KG-B192B	B19-2	13.0	2.0	35.0	28.0	19.0	5.0	10.0	B19-2F	
KG-B221B	B22-1	12.0	1.0	40.0	32.0	22.0	5.0	11.0	B22-1F	
KG-B222B	B22-2	13.0	2.0	40.0	32.0	22.0	5.0	12.0	B22-2F	
KG-B251B	B25-1	14.0	1.0	44.0	36.0	25.0	6.0	15.0	B25-1F	
KG-B252B	B25-2	15.0	2.0	44.0	36.0	25.0	6.0	15.5	B25-2F	
KG-B281B	B28-1	14.0	1.0	48.0	40.0	28.0	6.0	24.0	B28-1F	
KG-B282B	B28-2	15.0	2.0	48.0	40.0	28.0	6.0	25.0	B28-2F	
KG-B321B	B32-1	18.0	1.0	52.0	44.0	32.0	8.0	28.0	B32-1F	
KG-B322B	B32-2	19.0	2.0	52.0	44.0	32.0	8.0	30.0	B32-2F	
KG-B361B	B36-1	18.0	1.0	56.0	48.0	36.0	8.0	35.0	B36-1F	
KG-B362B	B36-2	19.0	2.0	56.0	48.0	36.0	8.0	35.0	B36-2F	
KG-B451B	—	15.0	1.5	75.0	55.0	45.0	8.0	44.0	B45-1.5F	
KG-B453B	—	16.5	3.0	75.0	55.0	45.0	8.0	46.0	B45-3F	